



HOTEL 24 SOUTH

Space	Total Square Footage	Meeting Room Dimensions	Ceiling Height	Rounds	Reception	Theater Style	Conference	Classroom	U-Shape	Hollow Square
Shenandoah Ballroom	4453	61'x73'	15'	350	450	400	N/A	350	65	80
Salon A or B	1113	30'5"x 26'5"	15'	60	100	80	24	60	30	36
Salon A & B	2226	36'5"x61'	15'	120	200	160	50	120	55	65
Salon C	2226	36' 5" x 61'	15'	120	200	160	50	120	55	65
Prefunction Area	786									
Colonnade Ballroom	2726	47'x58'	17'							
Main Level	2146	37'x58'	17'	100	150	120	40	60	30	40
Terrace Level	580	10'x58'	13'	N/A	N/A	N/A	N/A	N/A	N/A	N/A
Blue Ridge Room	488	16'6"x29'4"	14'	30	35	40	20	16	21	24
Skyline Room	325	19'6"x16'6"	14'	20	20	25	12	12	N/A	N/A
Staunton Board Room	199	12'x16'6"	14'	Preset Conference Table (8)						
Mezzanine Level										
Augusta Room	272	16'x17'	8'	20	40*	20	16	18	N/A	N/A

*w/ spillover to Mezzanine



- 40 miles from Charlottesville, VA
- 85 miles from Roanoke, VA
- 105 miles from Richmond, VA
- 155 miles from Williamsburg, VA
- 165 miles from Washington D.C.
- 210 miles from Virginia Beach, VA

Location

Staunton, Virginia is in the heart of the scenic Shenandoah Valley at the crossroads of I-64 and I-81. Only 2 hours from the Washington, D.C. metropolitan area, enjoy a beautiful drive through some of Virginia's most majestic valleys. Charlottesville is just 30 minutes and Richmond is just 90 minutes to the east. Hotel 24 South is conveniently located to three airports - Shenandoah Valley Regional, Roanoke Regional and Charlottesville - Albemarle Regional. Also the hotel is in close proximity to the historic working train depot which is serviced by AMTRAK.

Guest Room Accommodations & Amenities

Each of our 124 deluxe guestrooms, including 52 double queen and 52 king rooms offer ample accommodations with modern furnishings, décor, and art-work showcasing the unique architectural elements of downtown Staunton.

Additional amenities include:

- Complimentary Wi-Fi high-speed Internet access
- Cable TV with premium movie channels
- Complimentary weekday paper
- In-room coffee
- Hair dryer
- Iron and ironing board

Attractions

The hotel is adjacent to historic downtown Main Street, recently recognized by The National Trust for Historic Preservation as a winner of the Great American Main Street Award. Also within walking distance are five Historic Districts, the Blackfriars Playhouse (a re-creation of one of Elizabethan London's most famous theatres), Woodrow Wilson Presidential Library and Museum, Mary Baldwin College; and in close proximity are the Frontier Culture Museum and golf.

Dining & Entertainment

Magnolia South is open daily for breakfast and offers special event menus and holiday buffets. The 1924 Lounge offers a casual dining atmosphere specializing in cocktails, comfort foods and seasonal specialties.

Meeting & Banquet Facilities

Nearly 8,500 square feet of elegant meeting space includes the 2,700 square foot Colonnade Ballroom, with its restored 1924 one-of-a-kind Wurlitzer Organ; and the 4,453 square foot Shenandoah Ballroom, which can accommodate up to 400 for a banquet. The hotel also offers complimentary WiFi access throughout the meeting space, audio visual services, business services, and creative catering, as well as an executive boardroom and additional uniquely appointed conference rooms.

24 S. Market Street, Staunton, VA 24401

Phone: (540) 885-4848 or toll free: (866) 880-0024 • Fax: (540) 885-4840

www.hotel24south.com

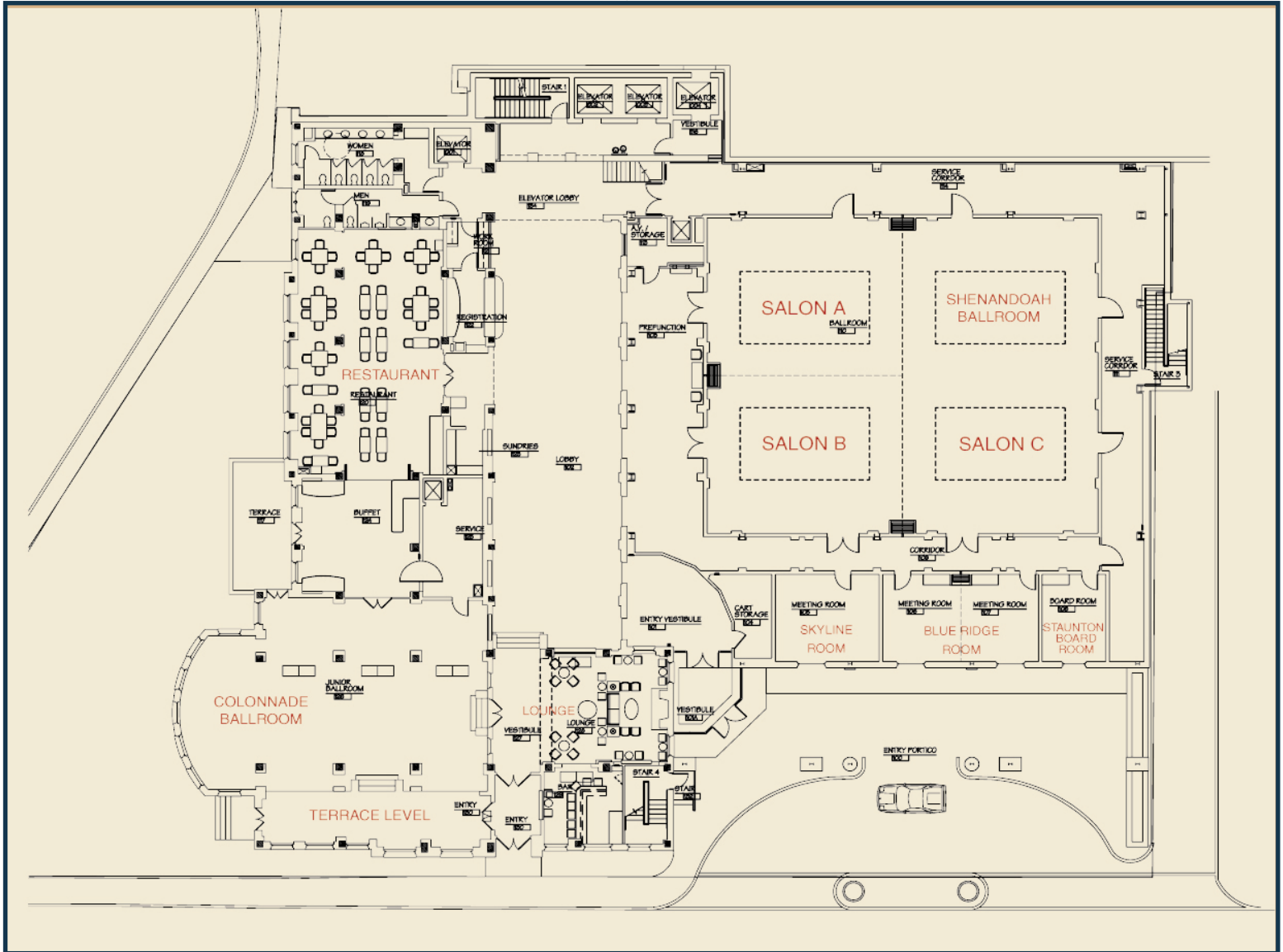

Additional Facilities:

Augusta Room
Business Center
Pool/Spa

Fitness Center
Guest Laundry
Attached Parking Garage

Hotel 24 South

24 South Market Street, Staunton, VA 24401 · (540) 885-4848 (PH) · (540) 885-4840 (FX) · www.hotel24south.com